

The image shows the exterior of a modern, multi-story office building at night. The building features a dark facade with large glass windows that are illuminated from within. A prominent feature is the illuminated signage on the upper part of the building. On the left, there is a circular logo with a stylized 'H' inside. To its right, the word 'BOSCH' is written in large, glowing red letters. The sky is dark blue, and the overall scene is lit by the building's interior lights and the signage.

WELCOME TO BOSCH CLAYTON

RBAU SITE INDUCTION
for **CONTRACTORS**

Version: 3
June 2019

Clayton Induction for Contractors

Course Outline

- ▶ Security Procedures
- ▶ Pedestrian Access
- ▶ Emergency Procedures
- ▶ Closing Statement



Clayton Induction for Contractors

Security Procedures

- ▶ While you are working at Bosch, you are required to comply with all security instructions.
- ▶ You must report to the security gatehouse upon arrival at and departure from Bosch in order to gain authorised entry and exit.
- ▶ You are required to sign in each time you enter Bosch.
- ▶ You must be accompanied by a Bosch employee at all times until you have completed the site induction process.
- ▶ You are required to wear your ID pass or visitor ID at all times.
- ▶ You are required to exit Bosch via the security gatehouse and sign out on departure and return your ID pass or visitor ID.

Clayton Induction for Contractors

Pedestrian Access

- ▶ Pedestrians have the right of way.
- ▶ If you operate Powered Mobile Plant (PMP), be aware of pedestrians and ensure you stop your PMP to maintain 3m separation.
- ▶ As a pedestrian, be aware of moving traffic and never assume the driver has seen you; maintain 3m separation from any moving vehicle.
- ▶ Ensure that you always use the designated pedestrian entrances and walkways provided.



Clayton Induction for Contractors

Emergency Procedures

► Alert Alarm

- Short pulse “beep, beep, beep”
- Do not evacuate.
- Wardens report to WIP phone,
- Wait for further instructions.

► Evacuation Alarm

- Long rising tone.
- Evacuate immediately taking safest, shortest route to designated assembly areas (with or without warden instruction!) Wait for further instructions at the assembly area; do not leave the site, do not re-enter buildings until all clear is given.

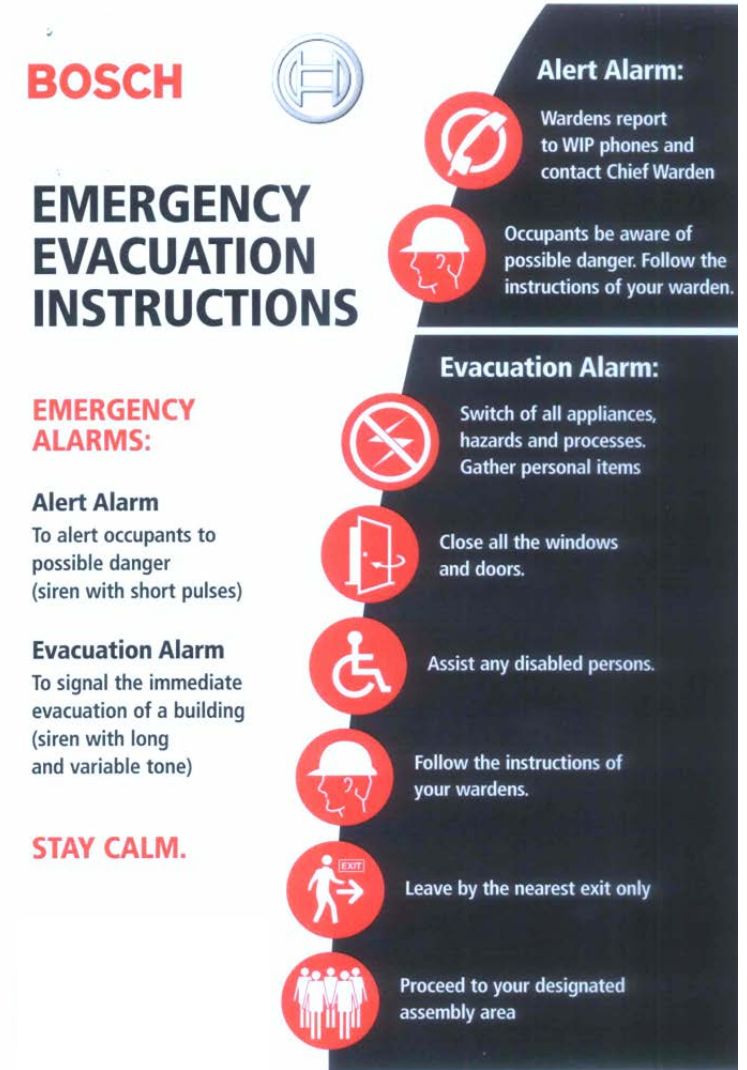

BOSCH 

EMERGENCY EVACUATION INSTRUCTIONS

Alert Alarm:
Wardens report to WIP phones and contact Chief Warden

Occupants be aware of possible danger. Follow the instructions of your warden.

Evacuation Alarm:
Switch off all appliances, hazards and processes. Gather personal items

Close all the windows and doors.

Assist any disabled persons.

Follow the instructions of your wardens.

Leave by the nearest exit only

Proceed to your designated assembly area

EMERGENCY ALARMS:

Alert Alarm
To alert occupants to possible danger (siren with short pulses)

Evacuation Alarm
To signal the immediate evacuation of a building (siren with long and variable tone)

STAY CALM.

Bosch Clayton Site Induction

Emergency Evacuation Areas

- ▶ There are two assembly areas for the site:
 - East side of CL120.
 - Front of CL120.
- ▶ Refer to maps in your areas for the shortest route to the evacuation area.
- ▶ Follow warden instructions.
- ▶ Do not re-enter the site until the all-clear has been announced.

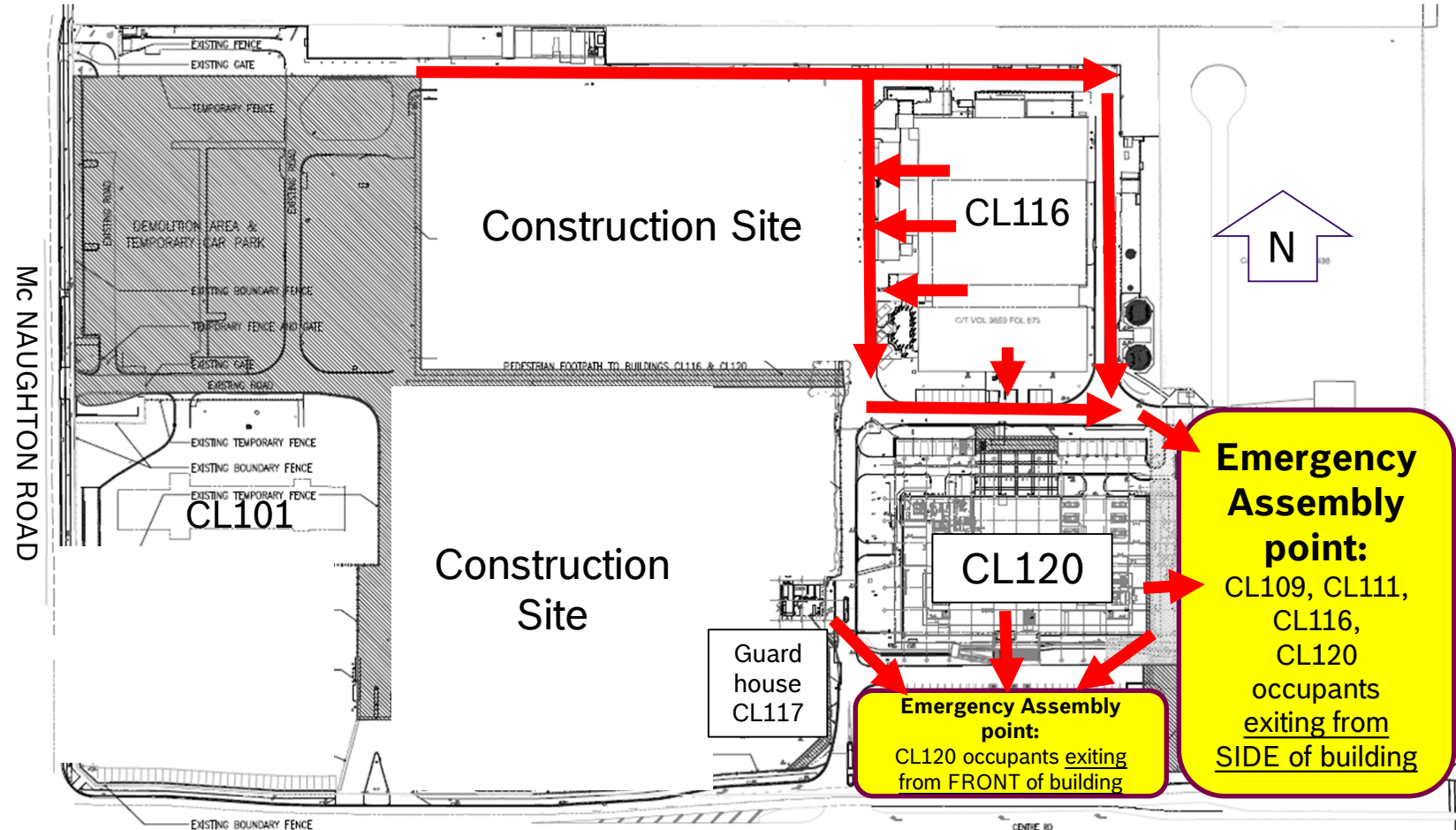

Clayton Induction for Contractors

Emergency Procedures (continued)

- ▶ First aiders are situated throughout the site. Ensure that you have been introduced to the first aider in the area where you are working.
- ▶ This information is also available via the intranet and Health & Safety notice boards.
- ▶ Ensure that you report all injuries to your first aider and supervisor. If a first aider is not available, contact security on **9541-5222** (emergency number)



If you are injured or ill...
You must report your
injury/illness to your first aider
IMMEDIATELY

Your Supervisor must also be notified

Clayton Induction for Contractors

Closing Statement

Safety is a team effort. Safety is not an option, it is a responsibility.

Every person on the Bosch site must act in a responsible and safety conscious manner, looking out for yourselves and looking out for others.

At Bosch, we will continue to provide you with a safe, healthy and clean environment in which to work.

Safety is about you, safety is about everyone, safety is about looking after each other and all going home safely at the end of each day.

RBAU Induction for Contractors

All Done!

Thank you for your time.

Contact your supervisor, host, or the HSE department if you have any questions.

